

Carbon Steel Needle Valve 6000 PSI

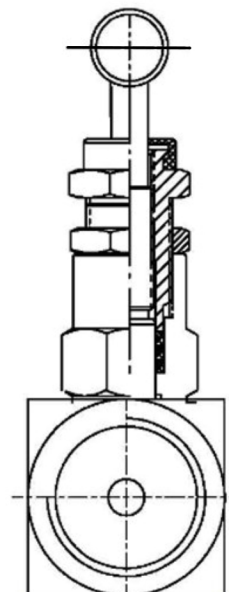
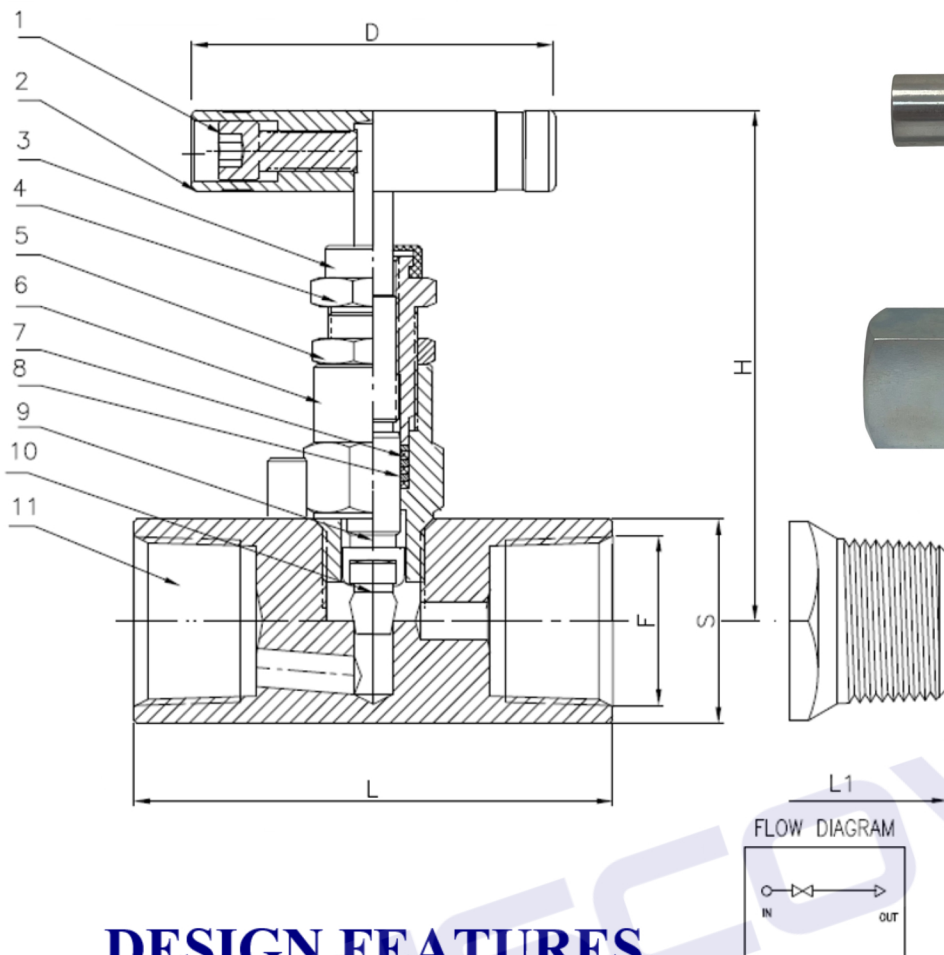

MATERIALS LIST

No.	Part Name	Material
1	Set screw	CS
2	Handle	CS
3	Dust cap	Plastic
4	Gland	A105
5	Nut	A105
6	Cap	A105
7	Packing	PTFE
8	Packing	Viton
9	Stem	316SS
10	Tip	17-4PH
11	Body	A105

DESIGN FEATURES

- Class: 6,000 PSI
- Seat: Delrin
- Temperature range: -20°F to 200°F
- Threads conform to ASME B1.20.1
- Meets NACE MR-01-75 requirements
- Bi-directional flow, with preferred flow indicated

DIMENSIONS

Part Number	Size (F)	L		S		H		D		L1		CV
	inch	inch	mm	inch	mm	inch	mm	inch	mm	inch	mm	
101037, 101039	3/8	2.95	75	1.26	32	3.86	98	2.24	57	3.23	82	0.85
101017	1/2	2.95	75	1.26	32	3.86	98	2.24	57	3.23	82	0.85
101018	3/4	4.25	108	2.01	51	5.39	137	4.25	108	3.23	82	2.18